

TCA THERMOWELLS BAR STOCK MACHINED

Thermowells are recommended for temperature sensors and thermometers in a process system to prevent damage to them from the pressure, velocity, abrasion and corrosive materials present in the process. The thermowell allows the removal and replacement of the temperature sensor without interference to the process gas or fluid.

Temperature Controls specialise in the design and manufacture of thermowells, we have gun drilling and CNC machining capabilities to ensure a quality product; timely delivery and competitive pricing.

We can supply thermowells in the following materials.

- 316;316L ;321; 321H; 304; 304L Stainless Steels
- Chrome Moly F11; F22
- Duplex and Super Duplex Stainless steel
- Inconel 600;601 or Incoloy
- Hastelloy C or B
- Monel 400
- Titanium Gr 2 or 12



Gun Drill Tip



Option: Plug & Chain

Quality Assurance

Testing and Certification Available for thermowells includes:

- Material Certificates
- Wake Frequency Calculations
- Full Penetration Welding X Ray
- Bore Concentricity
- Pressure Test Internal / External
- Dye Penetrant Testing of Welds
- NACE
- Weld WPS,PQR to ASME IX
- Positive Material Identification
- Hard Face Coatings available**
- Stellite
- Tungsten Carbide
- Hard Chrome



Screwed Reduced Tip Stem

SD 035

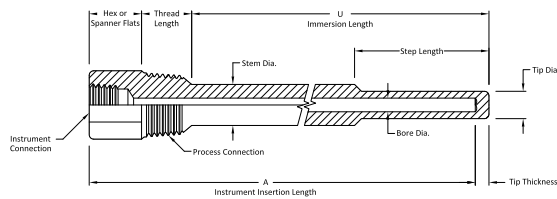

Screwed Parallel Stem

SD 039

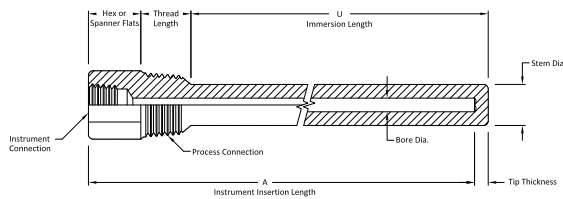

Socket Weld Reduced Tip

SD 743

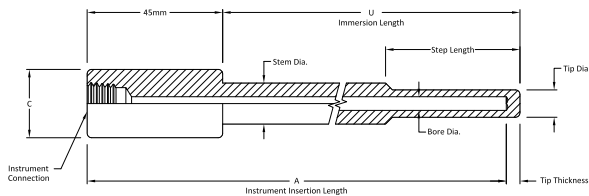

Screwed Taper Stem

SD 036FT

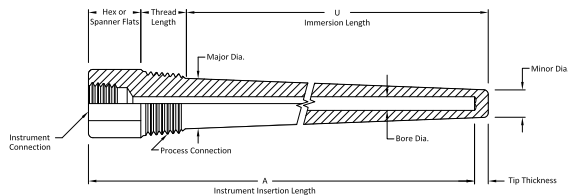

Weld in Taper Stem

SD 037

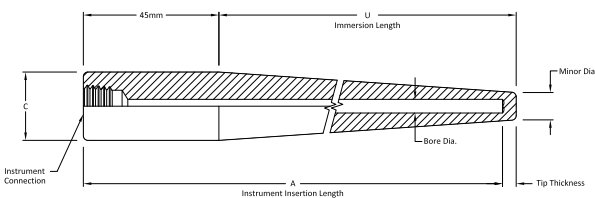

Welded Flange Taper Stem

SD 038FT

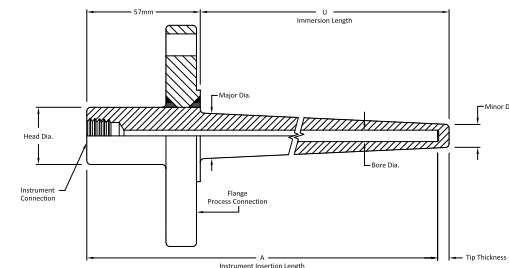

Sanitary Reduced Tip Stem

SD 744

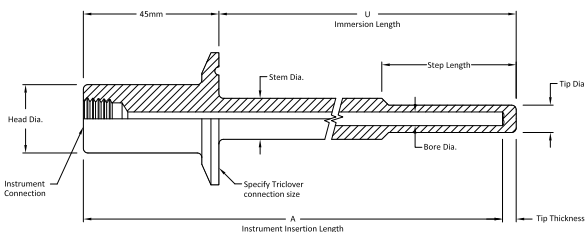

Van Stone Taper Stem

SD 667

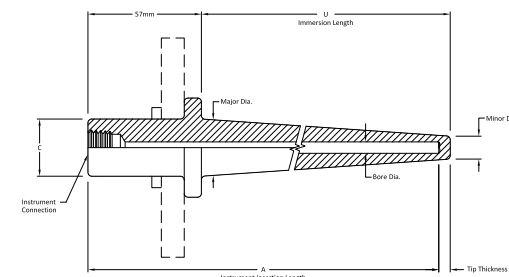

TCA EX STOCK BARSTOCK THERMOWELLS

Temperature Controls stock an extensive range of screwed Barstock thermowells in large quantities to suit thermocouples, RTD's and Bimetal thermometers; listed below are the most popular, contact our sales office to confirm current stock range.

Screwed Parallel Stem

SD 039

Screwed Taper Stem

SD 036



316 Stainless Steel
6.5 mm Dia Bore

Process Thread	Instrument Thread	U Length	Model	Price
1/2" BSPT	1/2" BSPT	50 mm	TC130050	\$
1/2" BSPT	1/2" BSPT	75 mm	TC130075	\$
1/2" BSPT	1/2" BSPT	100 mm	TC130100	\$
1/2" BSPT	1/2" BSPT	150 mm	TC130150	\$
1/2" BSPT	1/2" BSPT	200 mm	TC130200	\$
1/2" BSPT	1/2" BSPT	250 mm	TC130250	\$
1/2" BSPT	1/2" BSPT	300 mm	TC130300	\$
3/4" BSPT	1/2" BSPT	50 mm	TC140050	\$
3/4" BSPT	1/2" BSPT	75 mm	TC140075	\$
3/4" BSPT	1/2" BSPT	100 mm	TC140100	\$
3/4" BSPT	1/2" BSPT	150 mm	TC140150	\$
3/4" BSPT	1/2" BSPT	200 mm	TC140200	\$
3/4" BSPT	1/2" BSPT	250 mm	TC140250	\$
3/4" BSPT	1/2" BSPT	300 mm	TC140300	\$
1/2" NPT	1/2" NPT	50 mm	TC130050N	\$
1/2" NPT	1/2" NPT	75 mm	TC130075N	\$
1/2" NPT	1/2" NPT	100 mm	TC130100N	\$
1/2" NPT	1/2" NPT	150 mm	TC130150N	\$
1/2" NPT	1/2" NPT	200 mm	TC130200N	\$

Process Thread	Instrument Thread	U Length	Model	Price
1/2" BSPT	1/2" BSPT	50 mm	TC13T0050	\$
1/2" BSPT	1/2" BSPT	75 mm	TC13T0075	\$
1/2" BSPT	1/2" BSPT	100 mm	TC13T0100	\$
1/2" BSPT	1/2" BSPT	150 mm	TC13T0150	\$
1/2" BSPT	1/2" BSPT	200 mm	TC13T0200	\$
1/2" BSPT	1/2" BSPT	250 mm	TC13T0250	\$
1/2" BSPT	1/2" BSPT	300 mm	TC13T0300	\$
3/4" BSPT	1/2" BSPT	50 mm	TC14T0050	\$
3/4" BSPT	1/2" BSPT	75 mm	TC14T0075	\$
3/4" BSPT	1/2" BSPT	100 mm	TC14T0100	\$
3/4" BSPT	1/2" BSPT	150 mm	TC14T0150	\$
3/4" BSPT	1/2" BSPT	200 mm	TC14T0200	\$
3/4" BSPT	1/2" BSPT	250 mm	TC14T0250	\$
3/4" BSPT	1/2" BSPT	300 mm	TC14T0300	\$
1/2" NPT	1/2" NPT	50 mm	TC13T0050N	\$
1/2" NPT	1/2" NPT	75 mm	TC13T0075N	\$
1/2" NPT	1/2" NPT	100 mm	TC13T0100N	\$
1/2" NPT	1/2" NPT	150 mm	TC13T0150N	\$
1/2" NPT	1/2" NPT	200 mm	TC13T0200N	\$

TCA FABRICATED THERMOWELLS WITH MALE CONNECTOR

Fabricated thermowell with 1/2" BSPT Stainless Steel male connector welded to 9.5 mm diameter 316 stainless steel tube 1.2 mm thick wall. Designed to suit TC01 style temperature sensors. All units internal pressure tested during manufacture.

Screwed Parallel Stem

SD 350

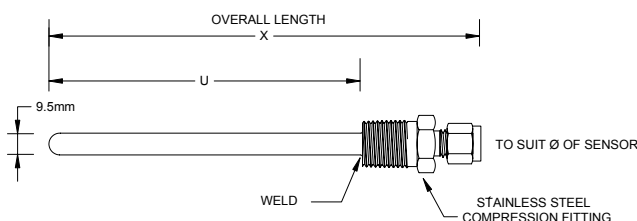

X LENGTH	U LENGTH	MODEL	PRICE
95 mm	50 mm	TC13CF50	\$
145 mm	100 mm	TC13CF100	\$
195 mm	150 mm	TC13CF150	\$
295 mm	250 mm	TC13CF250	\$